

Full Port Ball Valve

R910

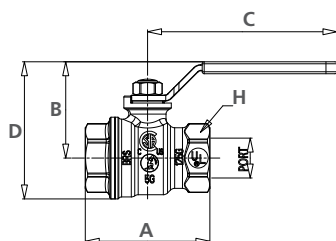

► FEMALE x FEMALE

Standard equipment:

Female NPT inlet and outlet, forged brass body, chrome plated ball with teflon seats.

CERTIFICATIONS



a/b	PORT	A	B	C	D	H
1/2"	19/32"	2-7/32"	1-7/16"	3-3/64"	2-5/64"	63/64"
3/4"	51/64"	2-15/32"	1-29/32"	3-3/4"	2-23/32"	1-7/32"
1"	63/64"	3"	2-1/16"	3-3/4"	3-1/32"	1-9/16"
1-1/4"	1-17/64"	3-13/32"	2-1/4"	3-3/4"	3-13/32"	1-55/64"
1-1/2"	1-37/64"	3-51/64"	2-49/64"	5-3/8"	4-15/64"	2-1/8"
2"	1-31/32"	4-23/64"	3-5/64"	5-3/8"	4-55/64"	2-5/8"
2-1/2"	2-1/2"	6-1/64"	4-23/64"	7-11/32"	6-21/32"	3-15/64"
3"	3"	6-13/16"	7-31/64"	7-11/32"	7-13/32"	3-25/32"
4"	4"	8-17/32"	6-1/64"	10-7/64"	9-31/64"	4-31/32"